

PHONE MANUAL

myPhone HALO Q+



Lot number: 201907

Thank you for choosing HALO Q+ device.

Please read the manual carefully.

myPhone HALO Q+ is a phone intended for use on the GSM 2G frequencies 850/900/1800/1900 MHz and 3G frequencies 900/2100 MHz. It has a contrasting, colourful display, a torch, Bluetooth and support for dual SIM.

Without prior written consent of the manufacturer, no part of this manual may be photocopied, reproduced, translated or transmitted in any form or by any means, electronic or mechanical, including photocopying, recording or storing in any systems of storing and sharing information.

Safety

Read these guidelines carefully. Not following them may be dangerous or illegal. Depending on the installed version of the software, service provider, SIM card or country, some of the descriptions in this manual may not match your phone, and the phone itself and its accessories might differ from the one included in the illustrations in this manual

–DO NOT RISK–

All wireless devices may cause interferences, which could affect the quality of other connections. *Do not switch the device on in places which are prohibited from using cell phones, or when it may cause interferences or other dangers.* Always abide by any kinds of prohibitions, regulations and warnings conveyed by the staff.

–ROAD SAFETY–

Do not use this device while driving any kind of vehicle.

–RESTRICTED AREAS–

Switch OFF your telephone in an airplane since it may disturb the operation of other equipment located therein. The telephone may interfere with operation of the medical equipment in hospitals and health protection entities. Abide by any kinds of prohibitions, regulations and warnings conveyed by the medical staff or warning signs.

–QUALIFIED SERVICE–

Only qualified personnel or an authorized service center may install or repair this product. Repairing by an unauthorized or unqualified service may cause device damage and warranty loss.

–WATER AND OTHER LIQUIDS–

Protect the device from water and other liquids. It can influence work and the life span of electronic components. Avoid using the device in environments with high humidity like kitchens, bathrooms or during rainy weather. Particles of water can cause the liquefaction of moisture in the device, and this may have a negative impact on the work of electronic components.

–CHILDREN AND PHYSICALLY OR MENTALLY DISABLED PEOPLE–

This device should not be operated by people (including children) with limited physical or mental abilities, as well as by people with no earlier experience in operation of electronic equipment. They may use the device only under supervision of people responsible for their safety. This device is not a toy. Memory card and SIM card are small enough to be swallowed by a child and cause choking. Keep the device and its accessories out of reach of children.

–ALARM CALLS–

Making alarm calls may not be possible in some areas or circumstances. It is recommended to find an alternative way to notify emergency services if you are going to this type of remote areas.

–PETROL STATIONS–

Always turn off the phone while refueling your car on petrol station. Do not use your device close to chemicals.

-BATTERY AND ACCESSORIES-

Avoid exposing the battery to very high/low temperatures (below 0°C/32°F and over 40°C/104°F). Extreme temperatures may influence capacity and battery life. Avoid contact with liquids and metal objects as it may cause partial or complete battery damage. The battery should be used according to its purpose. Do not destroy, impair or throw the battery into flames - it might be dangerous and may cause fire. Worn-out or impaired battery should be placed in a dedicated container. Excessive charging the battery can cause damage. Therefore, a single battery charge should not last longer than 1 day. Installing an incorrect battery type can cause an explosion. Never open the battery. Please dispose of battery according to the instructions. Disconnect an unused charger from power grid. In case of the charger wire damage, it should not be repaired but replaced with a new one. Use the original manufacturer's accessories only.



-HEARING-

To avoid hearing damage, do not use the device at high volume levels for a long period of time, do not put operating device directly to the ear.



-EYESIGHT-

To avoid eyesight damage do not look closely onto the flash light during its work. A strong beam of light may cause permanent eye damage!

Manufacturer:

mPTech Sp. z o.o.

Nowogrodzka 31

00-511 Warsaw

Poland

www.myphone.mobile.com

Made in China

Table of Contents

Table of Contents.....	3
Package content.....	5
Technical Specifications.....	5
1. Introduction	6
Appearance of the phone.....	6
Turning the phone on/off.....	8
Inserting SIM, memory cards and the battery.....	8
Charging the battery.....	8
Charging without the cradle charger.....	8
Charging with the cradle charger.....	8
2. Using the basic functions.....	9
Keypad lock.....	9
Phone menu access.....	9
Customize your phone.....	9
Sounds and user profiles.....	9
Turning the „Silent” mode on and off.....	10
Call handling functions.....	10
Calling.....	10
Answering.....	10
News.....	10
Creating and sending text messages.....	10

Messages display.....	10
List of contacts.....	10
Adding a new contact.....	10
Deleting contacts.....	11
SOS button settings.....	11
3. Using the basic functions.....	11
Calling a contact from the phone book.....	11
Missed calls.....	12
Speakerphone mode.....	12
Dual SIM open.....	12
Connecting your phone to the computer.....	12
International calls.....	12
4. Other phone features.....	12
Time and date settings.....	12
Menu language Menu.....	12
Displays setting.....	13
Call settings.....	13
Call register.....	13
Configuration of the alarm.....	13
Calculator.....	13
Factory settings.....	13
Torch.....	13
Media player.....	14
FM Radio.....	14
Calendar.....	14
Bluetooth.....	14
Pairing bluetooth devices.....	15
Sending files via Bluetooth.....	15
Camera.....	15
Taking pictures.....	15
Recording videos.....	15
Phone icons.....	15
Troubleshooting.....	16
5. Proper phone maintenance.....	16
Proper use of the battery.....	16
Device maintenance.....	17
Technological criteria.....	17
Information on certificates (SAR).....	17
Correct disposal of used equipment.....	18
Correct disposal of used batteries.....	18
Declaration of conformity with European Union Directives.....	18

Package content

Before you start using your phone, make sure all of the following items are included in the box:

- myPhone HALO Q+,
- battery,
- charger (adapter + USB cable),
- user manual,
- cradle charger.



If any of the above items is missing or damaged, please contact your dealer.



It is recommended to keep the packaging in case of any complaint. Keep the container out of reach of children.



The current manual or a more detailed version of this manual is also available on the manufacturer's website:

www.myphone.pl/qr/myphone-halo-q-plus

Depending on the installed version of the software, service provider, SIM card or country, some of the descriptions in this manual may not match your phone. Depending on the country, service provider, SIM card or device version, the phone and its accessories may differ from the illustrations included in manual. The descriptions contained in this manual are based on the default settings of the phone.

Technical Specifications

Two SIM card slots; hands-free mode; torch; FM radio, 2 Mpix camera; SOS button

Display: 2.8", 240x320 pix

Battery capacity: 1400 mAh

Memory cards support up to 32 GB

Input/output parameters Chargers: 100-240 V~ 0.15 A, 50/60 Hz

Output parameters Chargers: 5.0 V = 0.5 A

Dimensions: 130 x 56 x 13 mm

Weight: 110 g

1. Introduction

Appearance of the phone

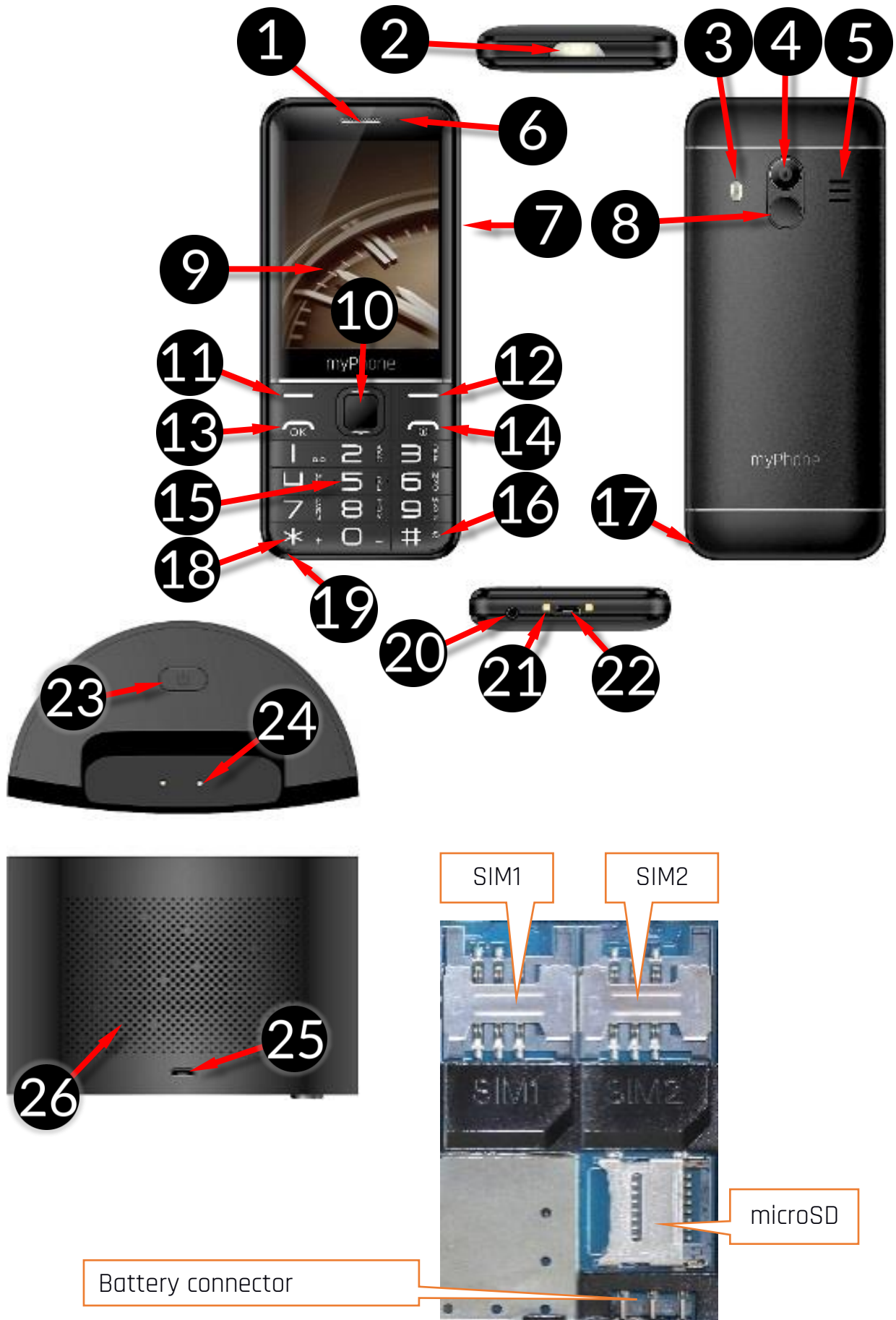

1	Speaker	A speaker used in phone conversations.
2	LEDs	Torch
3	LED	Camera flash
4	Camera	Camera lens
5	External speaker	Loudspeaker for system sounds, ringtones, music.
6	LED	Multicolor LED for notification of battery charging, incoming and missed calls and messages, as well as the audio player's functioning.
7	Torch on-off / FM Radio	Allows you to quickly turn on the torch (at any time) or FM radio (only with the active home screen).
8	SOS button	Press and hold to activate an alarm and/or auto-dial of predefined numbers.
9	Display	LCD display
10	<OK> button <Up> <Down> <Right> <Left>	The <OK> button on the home screen allows you to enter the Menu, where it confirms your selection. The direction keys in the menu allow you to navigate through it. On the home screen they activate: <Up> - camera, <Down> - photocontacts, <Right> - On/Off "Find Phone"*, <Left> - calendar.
11	<Menu> button	While on the main screen enables entering the Menu, and confirms choice while in the Menu. Locks and unlocks the phone keypad.
12	<Contacts> button	On the Mainscreen, launch the Phonebook. While in the menu you can exit or opt out.
13	<Green handset> button	Allows you to receive an incoming call or look through the list of all calls.
14	<Red handset> button	Allows you to reject an incoming call. While in the menu allows you to return to the main screen. While on the mainscreen it allows to turn off the display or turn it off or on again.
15	Phone keypad	Keys enabling dialling the phone number in the home screen, and entering the letters and numbers of the message body in the SMS writing mode.
16	<#> button	Use this option to increase the volume in multimedia applications. Allows you to switch between sound modes and character input modes when writing text messages.
17	Gap	Allows to take off a cover of the phone.
18	<*> button	Use this option to decrease the volume in multimedia applications. When writing an SMS, it displays symbols for insertion into the content.
19	Microphone	Do not cover it with your hand while on the phone.
20	3.5 mm minijack headphone	It allows you to connect headphones to your phone, so you can listen to the radio (improve the quality of reception - act as an additional antenna), music, and also make calls (when

	jack	headphones are equipped with a microphone).
21	Phone connectors	Allows you to connect to the base and charge the battery.
22	MicroUSB port	When connected, the charger enables recharging the battery. You can transfer data (photos, videos, music) when you connect it to your computer.
23	<Search> button	Enables to search for a phone by activating a sound.
24	Base connectors	Allows you to connect the phone to the base and charge the battery.
25	Base microUSB port	When the charger is connected, it allows you to charge the battery in the phone connected to the base and use the phone search option.
26	Base LED diodes	The LED indicates that the power supply is connected to the charging base.

Turning the phone on/off

To turn the phone on/off press and hold the <Red handset> button. If you are prompted to enter a PIN code as soon as the phone is switched on, enter the PIN code (you will see it as ****) and press the [Menu] key.

Inserting SIM, memory cards and the battery

If the phone is switched on - switch it off. Remove the back cover of the phone - use your fingernail to raise it using the gap in the case. Insert the SIM card/s - Card/s is/are supposed to be placed with its gold contacts facing down, the way in which the slot is placed.

Insert the memory card - to open the flip of the card reader slide it delicately down. Insert the microSD memory card with its gold contacts facing down, the way in which the slot is embossed. Close the flip by sliding it towards the center of the phone.

Insert the battery so that its gold contacts touch the tripple connector in the phone bay. Put on and gently press down the cover until you hear the click of the latches. Make sure the cover is well attached.

Charging the battery

Charging without the cradle charger

Plug the microUSB plug of the cable into the charging socket on your phone and the USB plug into the charging socket on the charger. Subsequently connect the charger plug into the power grid.

****Attention:*** Improper connection of the charger cable can cause serious damage to the phone and/or the charger. Damage caused by improper use of the phone and its accessories is not covered by the warranty.

The icon  (or similar) will appear during charging and when the battery is fully charged. When charging is complete unplug the charger from the power outlet. Unplug the cable from the socket on the phone.

Charging with the cradle charger

Plug the microUSB plug of the cable into the charging socket on your phone and the USB plug into the charging base socket, then plug the charger plug into the power

oulet. Place the phone in the charging base.

***Attention:** *Improper connection of the charger cable can cause serious damage to the phone, charger, and/or the charging base. Damage caused by improper use of the phone and its accessories is not covered by the warranty.*

2. Using the basic functions

Keypad lock

To lock the keyboard press [Menu] > <*> To unlock the keyboard press [Unlock] > <*>

Phone menu access

To access the phone menu, press the <Menu> button above the <green handset> or <OK> button with the phone's main desktop activated.

By pressing navigation buttons <up>, <down>, <left> or <right>, move to the wanted menu icon.

Press <Menu> or <OK> button to confirm your choice (and enter the menu item) or <back> to return to previous menu/desktop.

Customize your phone

myPhone HALO Q+ can be customized to your needs. This makes its use more enjoyable and easier.

Sounds and user profiles

To set ringtones and volume in the phone use [Profiles] option. To activate it, select [Menu] > [Settings] > <OK> > [Profiles] > <OK>. Choose the appropriate sound profile from the list and select <OK> to activate the selected profile or [Options] > [Customize] > [Select] to edit the profile according to your preferences. Available sound profile options:

- [Alert type] - allows to choose from: Ring only, Vibrations only or
- [Ring type] - allows to choose ring type, - "repeat" or "once" mode.
- [SIM 1 incoming call] or [SIM 2 incoming call] - option allows you to change incoming call ringtone melody for SIM 1 or SIM 2 -enter, choose the melody and confirm with <OK> button.
- [Ringtone volume] - allows to adjust the volume of the ringtone with <left> and <right> buttons. Confirm your choice with <OK> button.
- [SIM1 message] or [SIM2 message] - this option allows you to change the notification sound for SIM 1 or SIM 2. Enter, select the sound and confirm with <OK>.
- [Message volume] - Use <Left> and <Right> buttons to adjust the volume of the ringtone. Confirm your choice with <OK> button.
- [Keypad] - allows to chose the sound of the keypad (Silent, tone, click, vibration) with <Right> or <Left> buttons. Confirm your choice with <OK> button.
- [Keypad volume] - allows to adjust the volume of the keypad with <left> and <right> buttons. Confirm your choice with <OK> button.
- [Power on] - allows to chose wirh <Right> or <Left> keys the type of sound when turning on the phone (Silent, Tones). Confirm your choice with <OK> button.
- [Power off] - allows to chose wirh <Right> or <Left> keys the type of sound when turning off the phone (Silent, Tones). Confirm your choice with <OK> button.
- [System alert] - allows you to turn on or off system sounds of the phone.

Save the changes by [Options] >[Save].

Turning the „Silent“ mode on and off

The <#> key is used to switch sounds to vibration in the standby mode. Press and hold it for approx. 2 seconds until a profile activation message and profile symbol icon appear. By pressing and holding the <#> key again will return to the previous sound profile.

Call handling functions

Calling

Enter the number to the main screen using the numeric keypad.

We recommend that you enter the area code prior to the telephone number.

Unlock your phone and select a contact from the phonebook - [Phonebook]. Press <green handset> button to start the call. Press <red handset> button to finish the call.

Answering

Press <green handset> to answer an incoming call. Press <red handset> to finish/reject the call.

News

Creating and sending text messages

Enter: [Menu] > [Messages] > [Write message]. Type in the message using the keypad. Sings are typed in letter by letter.

The phone is not equipped with a dictionary. <#> button is used to change the writing mode. You can choose from, among others **Abc** - the first letter will be capital, the rest lower case, **abc** - only lowercase, **ABC** - only uppercase, **123** - digits only. To enter a diacritical character i.e. period, comma, dash, etc., press <*> and choose from the list, or press the 1 a correct number of times. To enter a space between the words press <0> button.

When you have entered the message, press [Options] > [Send to] and enter the number using the keypad or add it from the phone list. After entering the number/choosing a contact enter: [Options] > [Send], to send the message.

Messages display

Enter: [Menu] > [Messaging] > [Inbox], choose a message from the list and select [Options] > [View] to see the message itself.

List of contacts

Adding a new contact

Select: [Menu] > [Phonebook] > [Add new contact]. Enter the contact details: name, phone number. You can also assign a ringtone to a contact. Press [Options] > [Save] to save the contact.

Search for a contact

Select: [Menu] > [Contacts]. Enter the first letter of the contact. Phone numbers beginning with that letter will appear in the list. To find another contact use navigation buttons <Up> and <Down>. After searching and chosing a contact enter [Options] a list of available options will appear:

- [View] - to see the details of a chosen contact.
- [Send message] - to send text message to a chosen contact.

- **[Call]** - to make a call
- **[Edit]** - to edit the contact details.
- **[Delete]** - to delete the contact.
- **[Copy]** - to copy a chosen contact.
- **[Move]** - to move the chosen contact between the phone and SIM card memory
- **[Add to blacklist]** - to add to chosen contact to unwanted and blocked numbers.
- **[Mark several]**- to send SMS or a business card, save or delete the selected contacts.
- **[Caller groups]** - to create groups of contacts and add selected contacts to them.
- **[Photo call]** - to add the selected contacts to your photocontacts.
- **[Phonebook settings]** - allows you to set the location of contacts (SIM cards, phone memory, both), view the memory status, copy, move, delete contacts.

Deleting contacts

To delete all contacts from your phone, select: **[Menu] > [Phonebook] > <Options> > [Phonebook settings] > [Delete all contacts] > [OK] > select [From SIM 1], [From SIM 2] or [From Phone] and confirm with <OK>**. To delete a single contact, select: Select **[Menu] > [Phonebook] > search and select the contact to delete and select [Options] > [Delete] and confirm with <OK>**.

SOS button settings

myPhone Halo Q+ phone has got an SOS button. It is placed at the back of the phone. To activate the SOS button, select **[Menu] > [Settings] > [SOS Settings]**. A menu with the following settings will appear:

- **[Status]** - Here you can enable or disable the SOS function.
- **[SOS numbers]** - you can enter up to 5 numbers that your phone will call after pressing the SOS button for a longer time. Enter the phone numbers in the desired fields or select them from the phonebook. You can move between numbers using the **<Up>** and **<Down>** buttons. When you have typed in all the numbers, select **[Back]**.
- **[Warning tone]** - Here you can activate or deactivate the SOS sound alarm, which is activated by pressing the SOS button on your phone.
- **[SOS SMS text]** - it is possible to activate sending SMS with the given content to selected numbers or disable it, so that the phone will only try to reach the given numbers. You can also enter your own content of the emergency message, which will be sent to the specified number after pressing the SOS button. To save changes select **[Save]**.

We recommend that the emergency services number is one of the entries in the family numbers. The message should contain your name, home address and any serious illnesses (diabetes, coronary heart disease, etc.).

3. Using the basic functions

Calling a contact from the phone book

To call a number stored in the **[Phonebook]** submenu (phonebook), select **[Menu] > [Phonebook] > search for the corresponding contact (using the contact name keyboard), then select the contact and make a call by pressing the <Green handset> button and then select the SIM card.**

Missed calls

Missed calls are displayed on the screen of the phone. An appropriate icon on the screen will inform you about a missed call. To check who called, press **[View]**. Alternatively, select **[Menu] > [Call Center] > [Call History] > [Missed Calls]**.

To call back, select the missed call from the list, then press **<green handset>** to make a call and then select SIM card.

Speakerphone mode

During a call press **[Speaker]**, to activate speakerphone mode.

Dual SIM open

Dual SIM function enables using 2 SIM cards simultaneously. To use that function one should mount two SIM cards in the phone (SIM slots are placed beneath the phone battery). Subsequently enter **[Menu] > [Settings] > [Dual SIM settings]**. You have the following options to choose from:

- **[Dual SIM open]** - so that both SIM cards are enabled,
- **[Only SIM 1 open]** and **[Only SIM 2 open]** to activate SIM 1 or SIM 2.

If the Dual SIM option has been chosen on the phone, each time a call is made or a message sent, the phone will display a question about which SIM card to use.

Connecting your phone to the computer

myPhone HALO Q + can be plugged to the PC computer using a USB cable. This allows you to view and exchange data between your computer and your phone when a microSD card is installed. To do this, you must:

- Connect the microUSB connector to USB port in your phone then connect the USB connector to a USB port on your computer.
- An information about USB connection should be displayed on your phone screen.
- Choose **[Mass storage]** from the displayed list.

The phone is now connected to the computer. The contents of the phone memory can be viewed using Windows Explorer.

International calls

While on the main screen press the **<0>** (zero) button twice until the "+" sign appears. Enter the full phone number of the recipient (the country code and the telephone number), and then press **<green handset>** to make a call.

4. Other phone features

Time and date settings

To set time and date enter: **[Menu] > [Settings] > [Phone settings] > [Time and date]** and a list will appear:

- **[Set home city]** - to change the time zone in which the operator is located.
- **[Set time/date]** - to change the date and/or time.
- **[Set format]** - to set format of date and time.
- **[Update with time zone]** - to set automatic update of time zone.

Menu language Menu

To set the Menu language, press **[Menu] > Down > Right > OK > Down > Down > OK > Down > OK**, while the main screen is active, then select the desired menu language.

Displays setting

Select [Menu] > [Settings] > [Phone settings] > [LCD Backlight], and you will see options:

- [Brightness] - Change the brightness of the screen with the <Left> or <Right> buttons.
- [Time] - allows to set the backlight screen time with <Left> and <Right> buttons.

To set the brightness and backlight time of the screen, select <OK>.

Call settings

Available in [Menu] > [Call Center] > [Call Settings]. You can set up a waiting call, forwarding call and call barring. In [Advanced settings] you can set and edit the list of blocked phone numbers - [Blacklist], a list of numbers to which the user can call - [Whitelist], set automatic call duration reminder and select the mode of rejecting calls by any SMS.

Call register

To view the call log, select [Menu] > [Call Center] > [Call History]. The following positions are placed in there:

- Missed calls
- Dialed calls
- Received calls
- Delete call logs
- Call timers
- Text msg. counter

To enter one of the listed options one has to select it from the list and press <OK>.

Configuration of the alarm

Enter [Menu] > [Organizer] > [Alarm]. Select any item in the list and press <OK>. You can enable/disable the alarm, set the time of its activation, repeat (once, every day, custom), select the alarm sound, type of alarm (combinations of ringing and vibration). To confirm alarm setting enter: <Done>.

Calculator

Enter [Menu] > [Calculator].

Basic arithmetic operations can be performed using the numeric keypad (typing numbers, digits). Actions can be set using navigation buttons: <Up> - addition, <Down> - subtraction, <Left> - multiplication and <Right> - division. To see the result press <OK>.

Factory settings

To get back to factory settings enter [Menu] > [Settings] > [Restore factory settings], input the phone password and confirm by pressing <OK>. Password required to restore the factory settings is 1122.

Torch

To turn on the torch, slide the switch (7) on the side of the phone's casing upwards and the LED on the top of the phone's casing will turn on. Move the switch to the middle position to turn off the torch.

Attention: The light emitted by the LED has a strong focus therefore it is *unadvisable to look directly into the light. Not following this instruction may cause damage to your eyesight.*

Media player

Start the audio player by selecting **[Menu] > [Multimedia] > [Media Player] > [All songs]**. This application allows you to play music files in MP3, AAC, AMR, WAV, formats. To play a music file it has to be saved on the microSD memory card. When you start the application, music files will automatically be added to the playlist.

Attention: *Listening to the audio player too long or too loud can cause hearing damage.*

To enjoy the audio player use the following buttons:

Button	Function
<#>	Louder
<*>	Quieter
<Up>	Play/Pause
<down>	Stop

<Right>	Next track
<Left>	Previous track
<OK>	Options
1	Fullscreen

FM Radio

To use a built-in FM Radio, enter **[Menu] > [Multimedia] > [FM Radio]**. Pick one: **[Options] > [Automatic preselection search] > <Select>** to search for and save available radio stations. All found radio stations will be saved and available at **[Options] > [Channel list]**.

If the reception on the antenna built into the phone is too faint, connect the headset (not included), which serves as an external antenna.

Radio control is done using the following buttons:

Button	Function
<Right>	0.1 MHz up / Further
<Left>	0.1 MHz down / Previous
<#>	Louder
<*>	Quieter

<down>	On/Off
<Up>	Switches between 0.1 MHz search and radio station search
<OK>	Record radio

Calendar

To switch on the calendar, select **[Menu] > [Organizer] > [Calendar]**.

You can add events to the calendar, to which you can set reminders. Use the **<down>**, **<up>**, **<left>**, **<right>** buttons to navigate between calendar dates.

Bluetooth

The phone is equipped with a Bluetooth. It is used to wirelessly connect and exchange files with other devices equipped with Bluetooth. To use Bluetooth enter: **[Menu] > [Settings] > [Bluetooth]**. The following options are available:

- **[Power]** - by pressing **<ON>** or **<OFF>** the Bluetooth signal is switched off/on. When the module is switched on, it is indicated by an icon in the upper status bar.

- **[Visibility]** - enabling this function allows you to see your phone in the list of other Bluetooth enabled devices.
- **[My device]** - an option **[Search new device]** is situated here. It allows you to display a list of available Bluetooth devices in range. This feature allows you to connect to a device from the list.
- **[Search Audio Devices]** - this option allows you to search for Bluetooth enabled music playback devices.
- **[My name]** - the name visible to other Bluetooth devices can be typed in here. Default name is "myPhone Halo Q Plus".
- **[Advanced]** - this option allows you to select the audio track, save files sent via Bluetooth, access files and check the address of bluetooth module.

Pairing bluetooth devices

To connect to a Bluetooth device choose it from a list of available devices by entering **[Menu] > [Settings] > [Bluetooth] > [My device] > [Search new device]** then select a device from the list and press **[Pair]**. Both devices will display a message asking you whether your password is compatible or correct. Enter the same data on both devices or confirm compatibility and press **[OK]** to pair the devices.

Sending files via Bluetooth

To send the file on the memory card to a paired device, enter **[Menu] > [Organizer] > [File Manager] > [SD card]** or **[Phone] >** select the file to be sent and select **[Options] > [Send] > [Bluetooth]**, and search for the recipient device or add it from the list of paired devices. The file will be send after recipient' approval.

Camera

myPhone HALO Q+ is equipped with a camera with the possibility of taking pictures and recording videos.

Taking pictures



To take a photo one should open the camcorder app by entering: **[Menu] > [Camcorder]**. When you start the camera, place the subject you wish to photograph in the frame, and then press **<OK>** to take a photo. Then you can select **<OK>** to upload the photo or **[Options]** to delete or edit the photo. To take further photos press **<Back>**. Photos are saved by default in a "Photos" file in the phone memory or on the microSD memory card (if installed). You can view the pictures you have taken and all other by entering **[Menu] > [Multimedia] > [Image viewer]**.

Recording videos

To record a video enter **[Menu] > [Camcorder] > <Down>**. Then place the recorded object in the camera frame and press the **<OK>** (Record) button to start recording and **<Stop>** to finish. Videos are saved by default in a "Videos" file in the phone memory or on the microSD memory card (if installed). To watch videos enter: **[Menu] > [Multimedia] > [Media player]** .

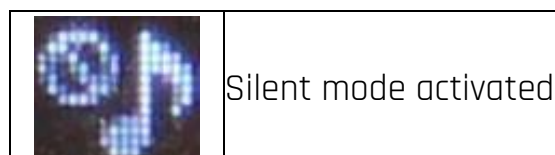
Phone icons



	"General" mode on
	Missed call
	Bluetooth ON

	Battery charge level
	Unread SMS message
	Plugged-in earphones

Troubleshooting

Message	Possible solution
Insert SIM card	Make sure SIM card has been correctly installed.
Input PIN	If the SIM card is secured with the PIN code you have to enter the PIN when turning the phone on and press <OK>.
Network fail	In areas where signal or reception is weak, calls may not be possible. Also receiving calls may not be possible. Move to another location and try again.
No one can call me	The phone has to be on and within GSM network reach.
I cannot hear the caller./The caller cannot hear me.	The mic. should be close to mouth. Check if the built-in mic. is not covered. When a headset is un use, check if it has been connected correctly. Check if the built-in speaker isn't covered.
Poor sound quality while on the phone.	Make sure that the speaker and mic. are not covered.
The connection cannot be established	Check if the typed-in phone number is correct. Check if the phone number entered to the [Phonebook] is correct. Enter the correct phone number if necessary.
If the problem persists, contact service center.	

5. Proper phone maintenance.

Proper use of the battery

Battery in this device can be charged with a charger. If the battery level is low, charge it. To prolong battery life, let it discharge beneath 20% of the battery capacity before connecting the charger and charge it up to 100%. If not used, unplug the charger from the phone and power grid. Overcharging or leaving in a too low/too high temperature or within magnetic field may shorten battery life cycle. The temperature of the battery has an impact on its charging cycle. Cool the battery or raise its temperature so that it is similar to the room temperature (approx. 20°C/68°F). If the battery temperature

exceeds 40°C/104°F the battery must not be charged! Use the battery only according to its intended purpose. Do not use a damaged battery. Do not throw the battery into flames! Do not throw a worn-out battery – send it or return it to an authorized recycling point.

Device maintenance

Keep your phone and accessories out of reach of children in a dry place, away from moisture, for extended the life of your phone. Avoid using the phone in high and low temperatures; it can shorten the life of phone electronic components, melt the plastic parts and destroy the battery. It is recommended that the phone is not used at temperatures higher than 40°C/104°F.

Do not try to disassemble the phone. Tampering with its structure in an unprofessional manner may cause serious damage to the phone or destroy it completely.

For cleaning use only a dry cloth. Never use any agent with a high concentration of acids or alkalis. Use the original accessories only. Breaking those rules might cause a loss of warranty.

Technological criteria

Network:

GSM 2G 850/900/1800/1900 MHz

GSM 3G 900/2100 MHz

Some services may depend on your provider, the state of your local cellular network, version of the SIM card used and the way you use your phone. For more information, please contact your GSM operator.

Attention	Statement
The manufacturer is not responsible for any consequences caused by improper usage of the phone and not obeying the above instructions.	The software version can be upgraded without earlier notice. The manufacturer retains the right to determine the correct interpretation of the above instructions.

Information on certificates (SAR)

Your mobile phone is a transmitter and receiver of radio waves. It is designed and manufactured according to current safety standards, so that exposure to radio waves never exceeds the limits set by the Council of European Union. Those limits establish the permitted levels of RF energy for the general population and were developed by independent scientific organizations on the basis of detailed scientific studies, including a large safety margin. Their purpose is to ensure the safety of all people, regardless of age and health. With regard to cell phones the level of exposure to radio waves is measured by the value SAR (Specific Absorption Rate), SAR is a value indicating the amount of radiation emitted by the phone. The SAR limit recommended by the Council of the European Union is 2 W/kg. The highest SAR value for **myPhone HALO Q+** equals **1.827 W/kg**.

The maximum radio frequency power emitted in the frequency range.			
Frequency Range	GSM 850/900/1800/1900 MHz	UMTS 900/2100 MHz	Bluetooth 2402-2480 MHz
Transmit Power	2W/1W	0.25W	2.1 dBm EIRP

Correct disposal of used equipment.



The device is marked with a crossed-out garbage bin, in accordance with the European Directive 2012/19/EU on used electrical and electronic Equipment (Waste Electrical and Electronic equipment - WEEE). Products marked with this symbol should not be disposed of or dumped with other household waste after a period of use. The user is obliged to get rid of used electrical and electronic equipment by delivering it to designated recycling point in which dangerous waste are being recycled. Collecting this type of waste in designated locations, and the actual process of their recovery contribute to the protection of natural resources.

Proper disposal of used electrical and electronic equipment is beneficial to human health and environment. To obtain information on where and how to dispose of used electrical and electronic equipment in an environmentally friendly manner user should contact their local government office, the waste collection point, or point of sale, where the equipment was purchased.

Correct disposal of used batteries



According to the EU directive 2006/66/EC with changes contained in EU directive 2013/56/UE on the disposal of batteries, this product is marked with crossed-out garbage bin symbol. The symbol indicates that the batteries used in this product should not be disposed with regular household waste, but treated according to the legal directives and local regulations. It is not allowed to dispose of batteries and accumulators with unsorted municipal waste. Users of batteries and accumulators must use the available collection points of these items, to be returned, recycled and disposed of.

Within the EU, the collection and recycling of batteries and accumulators is a subject to separate procedures. To learn more about existing procedures of recycling of batteries and accumulators please contact your local office or an institution for waste disposal or landfill.

Declaration of conformity with European Union Directives



mPTech Ltd. hereby declares that myPhone HALO Q+ cellular phone is compliant with Directive 2014/53/EU. The full text of the EU Declaration of Conformity is available at the following Internet address:

www.myphone.pl/qr/myphone-halo-q-plus